

**12-BAY PAEDIATRIC EMERGENCY  
12 CUBICLES**

**AMBULANCE  
ENTRY**

W.A.S. ENTRY

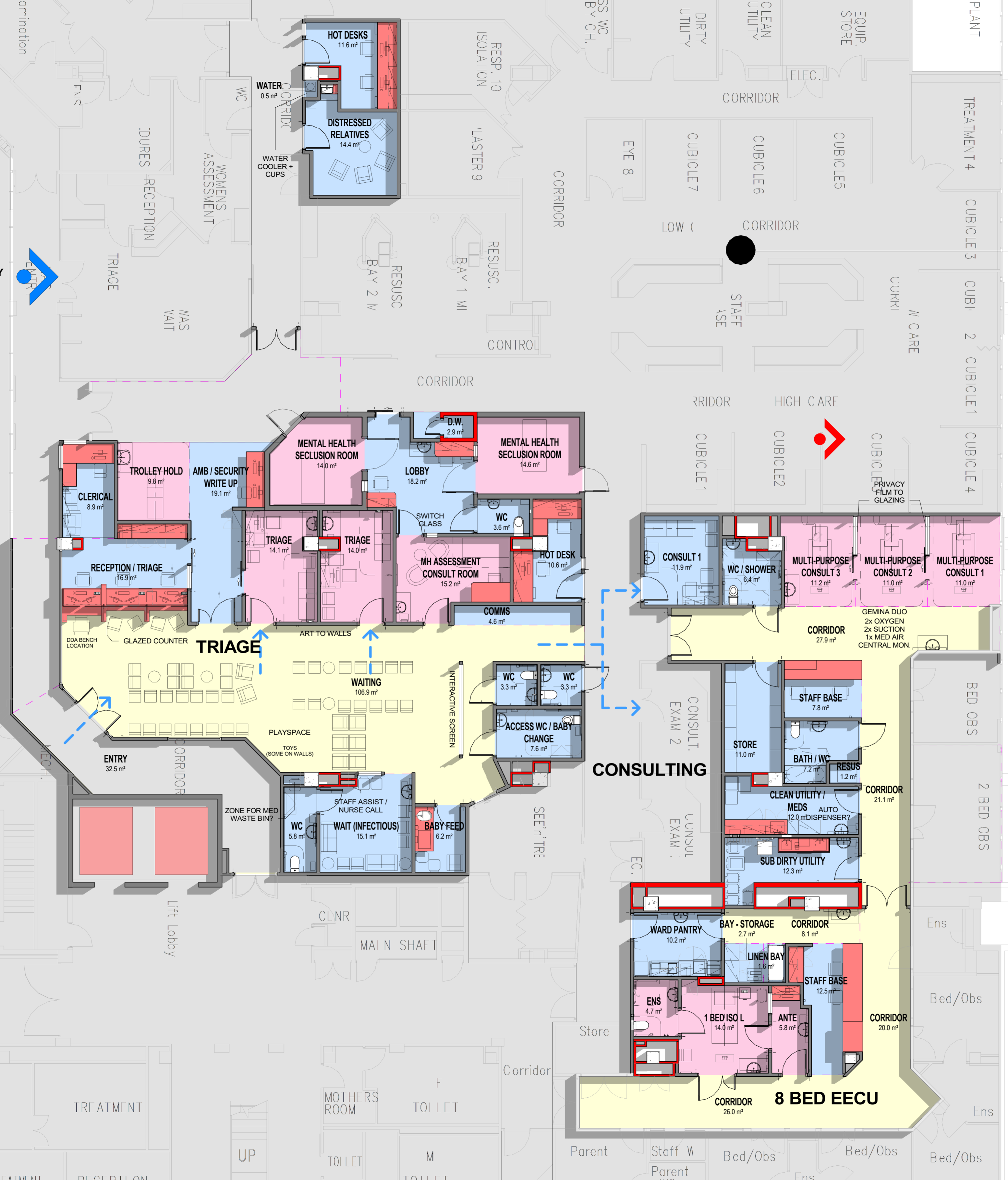

**CONSULTING**

**8 BED ECU**

2 BED OBS  
2 BED OBS

EMERG VEHICLE  
LOADING AREA

OBSERVATION AREA

TREATMENT

MOTHERS ROOM  
TOILET

Parent  
Staff W  
Parent  
Bed/Obs  
Bed/Obs  
Bed/Obs  
Bed/Obs